

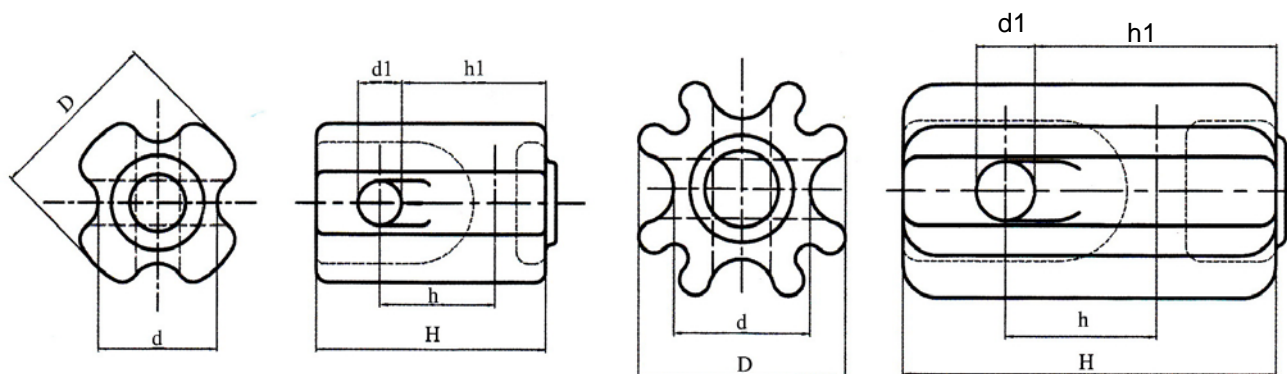

美标线路用拉紧绝缘子

STRAIN INSULATORS (ANSI Standard Type)



54-1
54-2
54-3

54-4

ANSI Class		54-1	54-2	54-3	54-4
Creepage Distance,mm		41	48	57	76
Dimensions,mm	H	89	108	140	171
	h	44	57	79	67
	h1	64	76	103	114
	D	64	73	86	89
	d	44	54	60	60
	d1	16	22	25	25
Mechanical Failing Load,KN		44	53	89	89
Power Frequency	Dry,KV	25	30	35	40
Flashover Voltage	Wet,KV	12	15	18	23
Net Weight,Approx.,kg		0.5	0.65	1.2	2.2

NOTE:

1. **Standard:**comply with the ANSI Standard C29.4
2. **Colour:**the glaze colors of the insulators are brown or light gray.